

KENT *Eternal*

HEPA
TECHNOLOGY

REMOVES
DANGEROUS
PARTICULATE
MATTER FROM AIR

HIGH CAPACITY



HOUSE of PURITY

Instruction Manual

Kent Air Purifier Banaye
**Sabse
Shudh Hawa**



HEPA Room Air Purifier
Remove Particulate Matter from Air

Welcome to KENT

Dear Customer,

At the outset, allow us to thank you for your trust in **KENT Eternal Air Purifier**. At **KENT**, we take pride in our reputation for product quality and industry proven performance. We are certain that your decision to own **KENT Eternal Air Purifier** will go a long way towards keeping you and your family in good health. We are confident that you will be more than satisfied with its performance and that it will serve your need for safer and purer living without any compromise.

This guide would help you in getting the best out of your **KENT Eternal Air Purifier**. Please go through the booklet to familiarize yourself with operation and maintenance.

You can look forward to years of trouble free service. To ensure that the warranty of your **KENT Eternal Air Purifier** is effective, it is important that you fill up the enclosed warranty card and mail it to us within 15 days of purchase.

In case you require any further information, please contact your nearest **KENT** dealer or branch.

Happy Living,
KENT RO SYSTEMS LTD.

Table of Contents

1. Why KENT Eternal Air Purifier	1
2. Salient Features of KENT Eternal Air Purifier	1
3. Know your product	1
4. Items in the box	2
5. HEPA Filter	2
6. Filtration process	2
7. Setting up the Eternal Air Purifier	2
8. Using KENT Eternal Air Purifier	3
9. Mode selection	4
10. Air Quality indicator	5
11. Cleaning and Maintenance	5
12. Precautions	7
13. Important safety instructions	8
14. Troubleshooting	9
15. Technical specifications	10
16. Spare part list	10

Why KENT Eternal Air Purifier

We at KENT have always believed that clean and healthy life is a right of every individual. This ethos is what made us to embark on the journey to develop innovative solutions for cleaning water, fruits, vegetable and air. With the use of an innovative technology and supported by a competent service network, we have been able to create a brand which has become synonym for well-being and health.

Continuing with the tradition, we now present the KENT Eternal Air Purifier, with state-of-the-art HEPA Technology to provide clean and particle free air.

We all know that with every passing day, the air quality is worsening. Perhaps what we are not aware of is that the air inside the house is more polluted as compared to air outside. This high concentration of pollutants especially dust particles have an adverse effects on our health.

Bacteria, dust, pollen, odors, hazardous gases (e.g., formaldehyde, benzene, etc.), soot, second-hand smoke, etc. are amongst the most common indoor pollutants. These pollutants have a high shelf life up to 240 hours in some cases. Inhaling these pollutants can lead to major complications like asthma, flu and other respiratory diseases.

On day to day basis, a city dweller, spends almost 90% of the time indoor (either in office or at homes), which means, the quality of indoor air is critical to one's health.

We sincerely hope that Kent Eternal Air Purifier will bring you and your family good health.

Salient Features of KENT Eternal Air Purifier

1. HEPA (High Efficiency Particulate Arrestor) Dust Collection Technology from JAPAN.
2. HEPA filter with antibacterial coating.
3. High-efficiency removal of PM 2.5-Particulate Matter.
4. Activated Carbon Filter removes odour.
5. Intelligent Air Quality monitoring.
6. Filter change indicator.
7. Low Noise operations.
8. User-friendly functional design, safe and convenient for use.
9. High purifying capacity purifies air in the room instantly.
10. Suitable for a room area upto 377 sq. ft.
11. Intelligent night mode.

Know Your Product

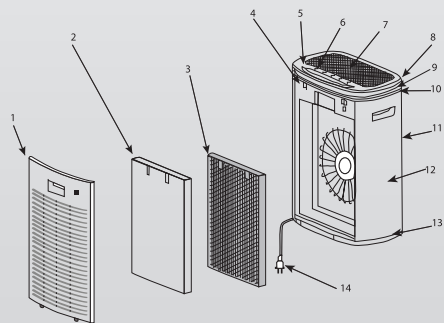

1. Back cover
2. Antibacterial HEPA Filter
3. Activated Carbon Filter
4. Central case cover
5. Top Panel
6. Button
7. Air outlet vents
8. Decorative ring
9. Support bracket
10. Support plate
11. Front cover
12. Left side panel
13. Base
14. Power cord

Items in the Box

1. KENT Eternal Purifier : 01 No.
2. User Guide: 01 No.

HEPA Filters

A HEPA (HEPA stands for high-efficiency particulate arrestor) is a type of mechanical air filter, which remove 99.97% of particles of size less than 0.3 microns (micron is one millionth of a meter) in diameter from the air passed through it.

HEPA uses three different mechanisms (Impact, Interception and diffusion) to catch and trap particles as they pass through in the air.

These three mechanisms allow HEPA filters to catch and trap carcinogens particles larger than 0.3 micron size like dust mites, mold spores, pollen, pet dander and tobacco smoke.

These carcinogens particles are highly injurious to health and are known to cause verity of health hazards like allergy, asthma and lung cancer. These particles cannot be removed by the normal filters available in the market.

Filtration Process

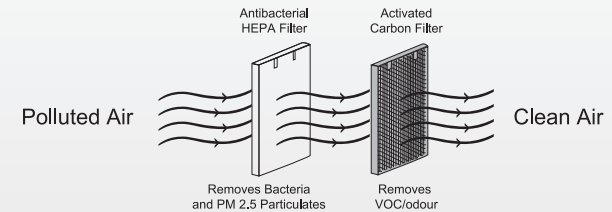

Setting up the Air Purifier

Your KENT Eternal Air Purifier is equipped with two filter for effective and efficient air filtration. Acting as a line of defense, each filter performs a customized role.

Filter 1: Antibacterial HEPA Filter

Antibacterial HEPA Filter not only removes suspended particles (SPN) PM2.5 from the air, but also purify PM 0.3 quite effectively. It also removes bacteria passing via the compound filter.

Filter 2: Activated Carbon Filter

The filter has been specially designed in a honeycomb layout which offers a better gas dynamics, compared to traditional filter. This unique design has lower volume density at the same time its surface area is larger. This allows a higher adsorption efficiency, and a smaller drag coefficient. It effectively adsorb formaldehyde as well as other volatile organic compounds (benzene, xylene, diene and odor etc.)

Installing Filters

The two filters used in KENT Eternal Air Purifier are shipped in a sealed form. Before starting the purifier for the first time, make sure all the plastic packing bags covering filters are completely removed.

1. Hold handle on the back cover and gently pull to open. Remove it and keep it aside (Refer the adjoining figure).



2. Remove Antibacterial HEPA Filter, as shown in the figure, by pulling the handle attached to the filters.



3. Remove Activated Carbon Filter, as shown in the figure.

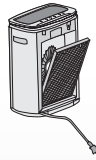

4. Remove plastic packaging on the filters and reinstall in the reverse order.



5. To put the back cover in the air purifier, Insert the snaps at the bottom of back cover into slots, and push the upper part in.

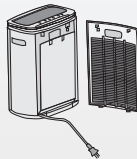

6. Always install the filters in correct position, by following the markings on the top of the filters.

Using KENT Eternal Air Purifier

1. Unpack the unit completely and remove any stickers that can prevent unit operation.
2. Install filters in the correct format.
3. Check the unit for damages, do not use it in case of any damages.
4. Before switching the unit on, make sure that your home mains voltage corresponds to the unit operating voltage.
5. Once connected to the main power supply, the appliance will make a three-tone sound indicating that it is ready for use.



6. To start the KENT Eternal Air Purifier, press ON/OFF button. The appliance will give a harmonious ringtone to indicate that it is on. In 3 seconds that appliance would start with in Auto-Mode.
7. To turn off the machine, press ON/OFF button.

Note: The purifier will reboot after power cut.

Mode Selection

For your convenience, the Air Purifier comes with three different modes. These different modes allow you to select a particular settings as per the needs.

Mode 1 - Auto

In this mode the Air Purifier automatically adjusts the settings (Speed - low, medium, high) based on the air quality sensed by order sensor. The current air quality is displayed by Air Quality indicator using different colours (blue, light blue, pink and red).

In Auto Mode, the appliance can differentiate between day and night and adjust itself accordingly. At night with lights turned off the purifier would enter into SLEEP MODE after 30 seconds. All the indicators on display and operations screen will turn off and the purifier will run silently allowing for a peaceful night.

In morning the purifier would come out of the sleep mode and resume its normal operations with settings depending upon the air quality.

To run the purifier in this mode, press ON button once.

Mode 2 - Silent

- In this mode the Air Purifier runs with less noise
- To run the purifier in this mode press MODE button on control panel once

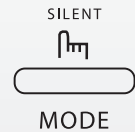

Mode 3 - Turbo

- Is recommended to run the purifier in TURBO mode if the room is heavily polluted or has high smoke/soot content
- To run the purifier in this mode press MODE button on control panel twice

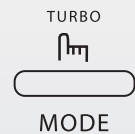

Speed

Kent Eternal Air Purifier comes with three different speed settings. These different speed settings-low, medium & high allow you to select a particular speed that suit the need.

To vary speed, press speed button on control panel

- For Low speed - press button once
- For Medium speed - press button twice
- For High speed - press button thrice

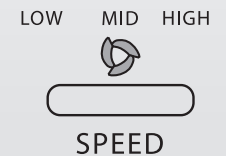

Timer

Kent Eternal Air-Purifier comes with three different timer settings. These different settings - 1 hour, 4 hours & 8 hours, allow you to select a usage as per your needs.

To set timer, press the 'TIMER' button on control panel

- To Set timer for 1 hour - press button once
- To Set timer for 4 hours - press button twice
- To Set timer for 8 hours - press button thrice



When the set time is up, the purifier will stop and turn off.

Filter Reset

When "REPLACE FILTER" LED glows, it indicates that the filters life is up and need to be replaced.

- Change filter screen 1 means replace "Activated Carbon Filter"
- Change filter screen 2 means replace "Antibacterial HEPA Filter"

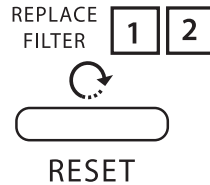

After replacing the filters, press and hold "RESET" button for 5 seconds to reset the 'REPLACE FILTER'.

Warning: It is important to reset the machine, failing to do so the photosensitive sensor might damage. It may also effect the smart mode operations

Air Quality Indicator

Kent Eternal Air Purifier comes with an inbuilt odour Sensor and display to indicate the Air Quality in the room. Kent Eternal Air-Purifier uses different colors: Red, Pink, Light Blue and Blue to indicate Air Quality.

BLUE: BEST

LIGHT BLUE: GOOD

LIGHT PINK: BAD

RED: WORSE

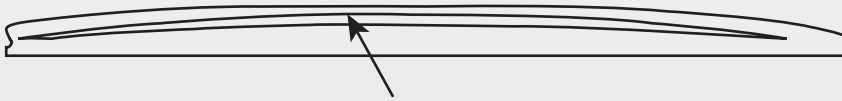

Note:

In the first 3 minutes after the machine is turned on, odor sensor is in preheat stage, so the air quality (odor) indicating lights in four colors will be flickering alternately.

When starting the machine for first time or after a long time around 30 to 60 minutes of pre-heating is required for the machine to reach stable condition. Any air quality information is only for reference before it becomes stable.

Cleaning and Maintenance

To keep your KENT Eternal Air Purifier spotless, please ensure a periodic cleaning of your purifier.

1. Switch off and unplug the appliance from mains power supply.
2. Wipe the appliance with a soft cloth to remove any dust or dirt.
3. In case of few stubborn marks, wipe with a soft cloth dipped in household detergent.
4. Do not use the machine till it is completely dry.
5. Do not clean the appliance by immersing it in water or under tap water. It might lead to major defects or breakdown of the appliance.

Cleaning or Replacement of Filters

Cleaning of Antibacterial HEPA Filter

1. Clean Antibacterial HEPA Filter once in every 2 weeks.
2. Do not rinse/wash in water.
3. To clean the filter, put it facing down on a newspaper or any other protective surface.
4. Clean its front side (the back does not require any cleaning or maintenance) with vacuum cleaner (using brush nozzle or crevice nozzle) to remove the dust on the surface.
5. Do not exert any excessive force on the Antibacterial HEPA Filter. Doing so might lead to its deformation.

Note: It is important that proper instructions are followed when cleaning or replacing of filter. Not adhering to proper procedures may impair the performance of the appliance.

Cleaning of Activated Carbon Filter

1. Clean Activated Carbon Filter once in a month with a soft brush.
2. Do not rinse/wash with water.
3. Put the filter in a place with sufficient sunlight and good ventilation for 2-3 hours. Then clean both sides of the filter with vacuum cleaner (using brush or crevice nozzle) to remove the dust on the surface.
4. Regular cleaning and maintenance would extend the life of filter components.
5. When the filter replacement indicator is on, replace with new filters within 2 weeks' time.

Note: Do not wash Activated Carbon Filter and Antibacterial HEPA Filter.

Precautions

1. Do not disassemble, or repair the appliance on your own. Doing so may cause appliance failure or breakdown.
2. The input voltage must not exceed the rating; doing so might damage the appliance.
3. Unplug before replacing the filter/cleaning/moving the appliance.
4. Do not use the appliance with damaged power cord or plug.
5. If power cord is damaged, replace it with a genuine KENT spare.
6. Do not install the machine in a high humidity area e.g., bathroom. The vapor may result in electric shock or breakdown.
7. Do not use the appliance in places with combustible liquids or heavy oil stain (e.g., machine oil). This may result in breakdown, electric shock or combustion.
8. Do not install the machine near any heat source, e.g., heater.
9. To maximize the effect of purification, it is recommended to put the machine on the floor and 30cm away from the wall.
10. Do not use the appliance for soot ejection or for ventilation in kitchen. This would result in reduced service life of the filter and even the appliance might get damaged.
11. Do not stick fingers or any other objects into the air outlet.
12. When using pesticide, turn off the appliance to prevent any chemical from being sucked in. The chemicals may accumulate in the machine and generate hazardous pungent substance under certain circumstances.
13. When the machine is used together with humidifier, prevent excess water vapor from entering into the machine, because water vapor could lead to electric shock and damage to the machine.
14. Do not block the air intake and outlet, which may otherwise reduce the machine's cleaning capacity (the indoor air may not be cleaned thoroughly) and result in machine breakdown.
15. Do not place the appliance near any water source such as fish tank or vase. If water enters into the machine, it may cause electric shock or malfunction.
16. If the machine is not be used for longer time, unplug it.
17. Do not sit, stand or shake the appliance.
18. Do not use the machine when it is in recumbent or inclined position.
19. Do not attempt to use the machine to remove any toxic substance, e.g., CO.
20. Do not use the machine at heavily smoky or dusty place, e.g., kitchen or where flammable gas, caustic gas or metal dust may have access, which may otherwise cause fire or failure.

Important Safety Instructions

When using an electrical appliance, basic precaution should always be followed, including the following:

1. Unplug, when not in use and before servicing.
2. To reduce the risk of electric shock, do not use near/on wet surfaces.
3. Use the appliance only as described in the manual.
4. Do not use the appliance, if cord or plug is damaged or worn out. Replace the damaged cord or plug immediately.
5. Do not try to service the appliance on your own. Send it to KENT authorized service center only.
6. Keep cord away from heated surfaces.
7. Do not unplug the appliance by pulling the cord. Always unplug by pulling the plug and not the cord.
8. To avoid electric shocks, do not use the appliance with wet hands.
9. Keep hair, loose clothing, fingers and all parts of body away from moving parts.
10. Turn all controls off before unplugging.
11. Never use the appliance without filter in place.
12. This appliance is suitable for Indoor use only.
13. Keep away from children.
14. The appliance is not designed to be used by people who are physically or mentally disabled or mentally handicapped or lack of relevant experience and knowledge, unless a person responsible for their safety uses the product for supervision or guidance.
15. Do not put the product directly under the air conditioning, to prevent condensation of water droplets into the product.

Trouble Shooting

Problem	Possible Cause	Possible Solutions
Air not coming out	Motor doesn't work.	Call KENT authorized service center.
There is no effective purification	The machine is installed at a poorly ventilated place or there is obstacle nearby.	Remove the obstacle.
	Antibacterial HEPA Filter and Activated Carbon Filters are overused and require replacement.	Replace Antibacterial HEPA Filter and Activated Carbon Filter.
Foul odors from the air purifier.	The foul odors may be due to excessive smoking in a shorter interval of time.	The odors will disappear after a while.
	Antibacterial HEPA Filter is overused and has not been replaced.	Change the Antibacterial HEPA Filter.
	In some extreme cases Antibacterial HEPA Filter needs to be dried or replaced in months or even weeks depending on different operating environment).	Put the Antibacterial HEPA Filter in a place with sufficient sunlight or good ventilation for 2-3 hrs to evaporate the moisture (do not dry it under direct sun, which may distort the filter and impact its performance).
The appliance automatically enters into sleep mode at night even though the light is on (or indoor illuminant is available)	The appliance may be placed in a dim-light corner.	Place the machine in a brighter area.
The appliance does not enter into sleep mode at night even with the light off.	The appliance is not running in smart mode.	Select smart mode and run the machine.
	Light from outside prevents the machine from entering into sleep mode.	Block the light from entering, by closing the doors/window or by drawing the curtain etc.

Technical Specifications

Product	KENT ETERNAL AIR PURIFIER
Product Code	115001
Product Generic Name	Air Purifier
Product Colour	Maroon
Mounting	Pedestal
Net Weight	8.90 kg
Input Power Supply	Single Phase 220- 240 V, AC 50/60 Hz. <input type="checkbox"/>
Product Dimension (mm)	402 (L) X 247 (W) X 555 (H)
Effective Room Area	Upto 377 sq.ft.
Noise (dB)	<= 65 dB (A)
CADR (Clean air delivery rate)	400 m ³ /h
Power Consumption	52 W

Spare Part List

Replacement of the spare part are as under:

1. Antibacterial HEPA Filter.
2. Activated Carbon Filter.

Note: The filters are consumables. There replacement time depends upon the quality of air being purified. They are not covered under warranty.