



Instruction Hand Book for Installation, Operation and Maintenance.



Kent Ozone Air Purifier
Wall-Mountable

Welcome to KENT

Dear Customer,

Welcome to the world of **KENT, the leading brand in the water purification industry in India.** With a **KENT** product you have all the reasons to smile as at **KENT** we take pride in the quality and laboratory-tested performance of our products.

We are confident that your decision to own **KENT Wall-Mountable Air Purifier** will go a long way in serving you with purified, fresh & detoxified air - thus keeping you and your family in good health. We assure that you will be satisfied with its trouble-free performance and quality.

This manual is an effort towards acquainting you with the operation and maintenance of **KENT Wall-Mountable Air Purifier.** **Read this manual carefully before using the product and keep it for future reference.** To enjoy the benefits of warranty, fill up the enclosed warranty card and send the installation report within 15 days of purchase. For further assistance contact your nearest **KENT** dealer or branch.

Best Wishes,

Kent RO Systems Ltd.

Table of Contents

1. Air Pollution: An Evil Taxing the Modern Life	1
2. The KENT Wall-Mountable Air Purifier: The Solution	1
3. Benefits of KENT Wall-Mountable Air Purifier	1
4. Salient Features of the KENT Wall-Mountable Air Purifier	1
5. KENT Ozone Technology	2
6. What is Ozone?	2
7. The Benefits of Ozone	2
8. Ozone – as recommended by W.H.O?	3
9. Electrical Specifications	3
10. Items in the box	4
11. Usage	4
12. Installation Guidelines	4
13. Operational Instructions	5
14. Maintenance	7
15. Cautions	7
16. Troubleshooting	7
17. Warranty	8

Air Pollution: An Evil Taxing the Modern Life

The air pollution also known as atmospheric pollution has become a complex issue to deal with. It has been defined by W.H.O (World Health Organisation) as the presence of harmful materials in excessive concentration which adversely affect the living beings and natural environment. Large scale industrial, automobile and volcanic emissions (of fumes) are the major factors responsible for this pollution. Some other factors degrading the air quality are virus, bacteria and micro organisms. This is the reason why many people in the cities today are developing cardiovascular & lung diseases.

Kent Wall-Mountable Air Purifier: The Solution

The Kent Wall Mountable Air Purifier is a solution made to enhance the quality of your life by making the surroundings ethereal. After being turned on, it quickly emancipates the room's atmosphere from harmful bacteria, pathogens, micro organisms, viruses, smoke, chemicals, etc. This is a custom made gadget which guards its user from harmful and highly contagious airborne diseases i.e. SARS, H1N1, etc. It occupies just L400 X W100 X H200mm of space and uses a power socket for executing the air purification operations in a room. It discharges the powerful ozone gas for eradicating all forms of the air pollution in the room.

Benefits of KENT Wall-Mountable Air Purifier

- Deodorizes: This device rapidly neutralizes the stale or foul odour, making the room environment fresh.
- Healthy: It oxidizes and decomposes formaldehyde for enhancing the user's health.
- Disinfect: Efficiently eliminates bacteria from the room's atmosphere

Salient Features of the KENT Wall-Mountable Air Purifier

- Performs fully automated air purification operations.
- Discharges the powerful ozone to purify air.
- Enables user to regulate the ozone discharge level.
- Removes harmful bacteria, pathogens, micro organisms, viruses, smoke, chemicals, etc. from the room's atmosphere.
- Programmed with three cycle modes and timing modes.
- Cost effective and easy to use ozonator.
- Easy to clean mechanism.

KENT Ozone Technology

KENT Wall-Mountable Air purifier uses ozone gas to purify the air in your immediate environment. Ozone gas is known to have an exceptional power to remove germs, chemical and other pathogens. It is a resourceful oxidising agent with inherent competence to exterminate bacteria, viruses and micro organisms from the air with precision.

What is Ozone?

Ozone is defined by the chemical formula of O_3 - a tri-atomic molecule holding three oxygen atoms. It was German-Swiss Chemist, Christian Friedrich Schönbein who proposed ozone as a new chemical substance after the Greek word ozein in 1840 – and the formula O_3 was determined for it in the year 1865. In nature, Ozone is formed because of the exogenic pressure of ultraviolet rays and atmospheric electrical discharges on dioxygen. This powerful oxidant is abundantly present in the Earth's atmosphere. The stratosphere (at 10 to 50km altitude) of the Earth's atmosphere holds the Ozone layer in low concentrations. Here, it absorbs 97 to 99% of the Sun's ultraviolet rays and prevents them from entering the earth's surface. On Earth's surface it can be found in abundance near seashores and forests.

Sadly, air pollution is quickly depleting the ozone level in atmosphere. This is the reason, why it is difficult to find ozone in metropolitan cities. The depletion of ozone layer has made it imperative for us to find alternative sources of ozone.

Benefits of Ozone

Ozone possesses strong oxidative properties which are 1.5 times more effective than chlorine in eliminating harmful colon bacillus, staphylococcus, flu viruses, bacteria, etc. The countries with technical competence are already using it for medical & commercial purposes. Europe was the first continent to benefit from the advantages of ozone generator used on medical water disposal.

The concept of using oxygen and ozone for therapies has been prevalent since the late nineteenth century. In 1856, many European hospitals started using ozone for disinfecting the operating rooms. After few years, Ozone became a part of the water purification process in Germany.

Dr. J. A. Fontaine was the first person to use pure oxygen in 1879 for treating his patients. The German Doctor, Albert Wolff made some more spectacular revelations in 1915 and used ozone for treating the skin diseases. During World War I, ozone played a vital damage control role in the German camp by healing wounds and anaerobic infections of the soldiers. By 1950, ozone established a strong reputation for curing cancer and many other diseases like tumour. Since 1990, many doctors have been using the ozone therapy in different ways for curing patients.

Ozone – as Recommended by W.H.O?

A very popular research report of W.H.O (World Health Organisation) has revealed that it is safe to use ozone concentration level up to 0.6 ppm. In such a controlled environment, ozone harmlessly removes smell (of cigarette, decaying rodents, paint, urine, etc.), unpleasant odours from the room and increases human metabolism.

Electrical Specifications

MODEL	KENT Wall Mountable Air Purifier
Voltage	DC 12V/ 1000mA
Rated Power Dissipation	9.6W
Ozone Output:	150 mg/h
Airflow	2.8 Km/h
Size	L 400 X W 100 X H 200mm
Weight	1210g
Condition Temperature	0°C ~ 40°C
Accessory	Adapter OUT/DC ... 12V

AC - DC Adapter Specifications

Input : 140 – 300 VAC ☐
 Frequency : 47 – 53Hz
 Output : 12V DC, 1000mA, 9.6 Watts

Caution

- Use only genuine & Kent certified adaptor for the device.
- If the adapter is damaged then purchase it from Kent or its authorised dealer.

Items in the Box

- ~ The Kent Wall Mountable Air Purifier
- ~ Manual
- ~ Warranty Card
- ~ Locating Sticker
- ~ One Set of Plastic Wall Insert
- ~ One Set of Screw
- ~ Adapter
- ~ Remote
- ~ One Set of Pencil Cell
- ~ Filter mesh

Usage

- For removing the stale & foul smells from a room use the device for at least 30 minutes.
- Mount the device at a high place as Ozone is heavier than air.
- Please set the operating function before leaving the house everyday.
- Do not use the device in an airtight room for a long period.

Installation Guidelines

1. Select an appropriate position for the device.
2. Place the hanging board locating sticker on the wall – where the device needs to be mounted.
3. Drill holes as per the space provided in sticker.
4. Now, insert the puff up (screw) bolt and screw the hanging board on wall.
5. Place the device on hanging board hangers and ensure that it is in a balanced position.
6. Now, the device is ready to use.

Wall Hanging Diagram

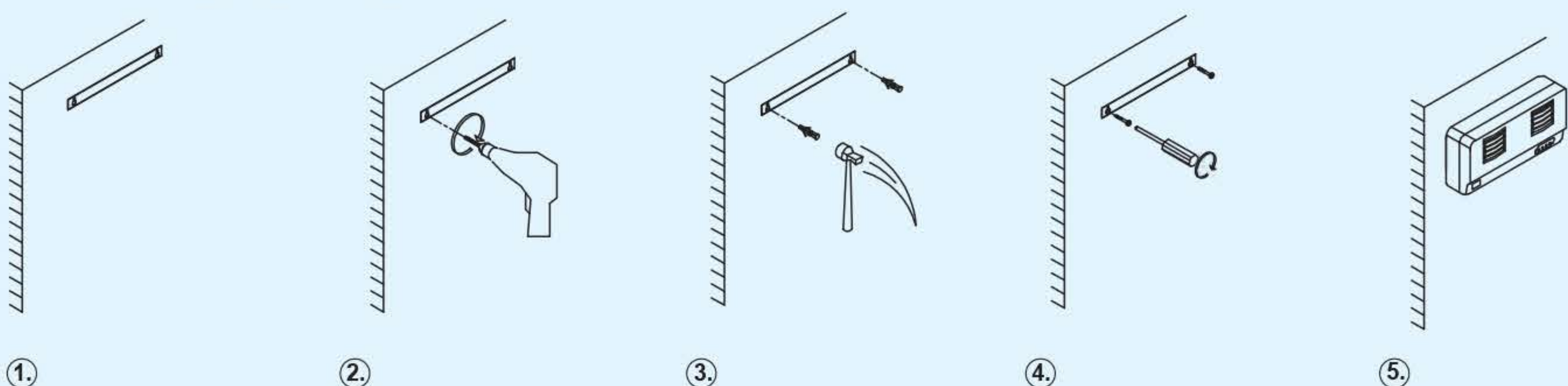

Note: If the wall is not straight or the screws are not properly drilled in an even position, the device might shake and produce strange sounds. In such a situation, place a rubber pad between the device and wall.

Note: Keep the device away from heat or direct sunlight.

Operational Instructions

[1.] Once the Power Socket is inserted into the Power Source, the Red, Green & Yellow LED lights blink simultaneously for three times which indicates that the device is ready to use.

[2.] Cycle Mode Settings:

I.) High Cycle Mode

Press the Power Switch, then the Red LED Light flashes to indicate that the device has been set in the High Cycle Mode. In this mode, the fan & the ozone generator start their operations simultaneously. For the first 3 minutes, the ozone generator produces ozone and the fan dissipates it. In the 4th minute, the ozone generator stops functioning but the fan continues dissipation. For the next 6 minutes both the ozone and fan stop their operations and go into a dormant stage. This process maintains the PPM level in a room. The cycle repeats itself till the Power On/ Off button is pressed again.

II.) Medium Cycle Mode

For changing the High Cycle Mode into the Medium Cycle Mode press the Cycle Mode Button (on timer). After this the Green LED Light indicates that the High Cycle Mode has been changed to Medium Cycle Mode. In this mode, the fan & the ozone generator start their operations simultaneously. For the first 2 minutes, the ozone generator produces ozone and the fan dissipates it. In the 3rd minute, the ozone generator stops functioning but the fan continues dissipation. For the next 7 minutes both the ozone and the fan stop their operations and go into a dormant stage. This process maintains the PPM level in a room. The cycle repeats itself till the Power On/ Off button is pressed again.

III.) Low Cycle Mode

For changing the Medium Cycle Mode into the Low Cycle Mode press the Cycle mode button twice. Then the Yellow LED light flashes to indicate that the Low Cycle Mode has been activated. In this mode, the fan & the Ozone Generator start their operations simultaneously.

For 1 minute, the ozone generator produces ozone and the fan dissipates it. In the 2nd minute, the ozone generator stops functioning but the fan continues dissipation. For the next 8 minutes both the ozone and the fan stop their operations and go into a dormant stage. This process maintains the PPM level in a room. The cycle repeats itself till the Power On/ Off button is pressed again.

IV.) The Cycle Mode settings can be changed anytime after pressing the ON Timer button.

3.] Timing Mode Settings

I.) Timing Mode: High Cycle

Turn on the device by pressing the Power Switch. Now press the Timing Mode Button (Off Timer) once. The HI Mode Red LED Light and OZ LED Light would blink continuously to indicate that the device has been timed in the High Mode. The device in this mode can continue operations for 6 hours.

II.) Timing Mode: Medium Cycle

Press the Timing Mode Button (off timer) twice. Then the Medium Mode Green LED and the OZ LED lights would blink continuously to indicate that the device has been timed in the Medium Mode. This Timer Mode runs the device automatically for 3 hours.

III.) Timing Mode: Low Cycle

Press the Timing Mode button (Off Timer) thrice. After this, the Low Mode Yellow LED and OZ LED Lights would blink for indicating that the device has timed in the Low Mode. This Timer Mode runs the device automatically for 1 hour.

IV.) The Timing Mode settings can be changed anytime by pressing the OFF Timer button.

* NOTES:

- The device registers the recently used settings before turning off.
- When a user turns the device on, it uses the most recently used settings – which can be changed by the user as per the requirement.

KENT Ozone Air Purifier (Wall-Mountable)

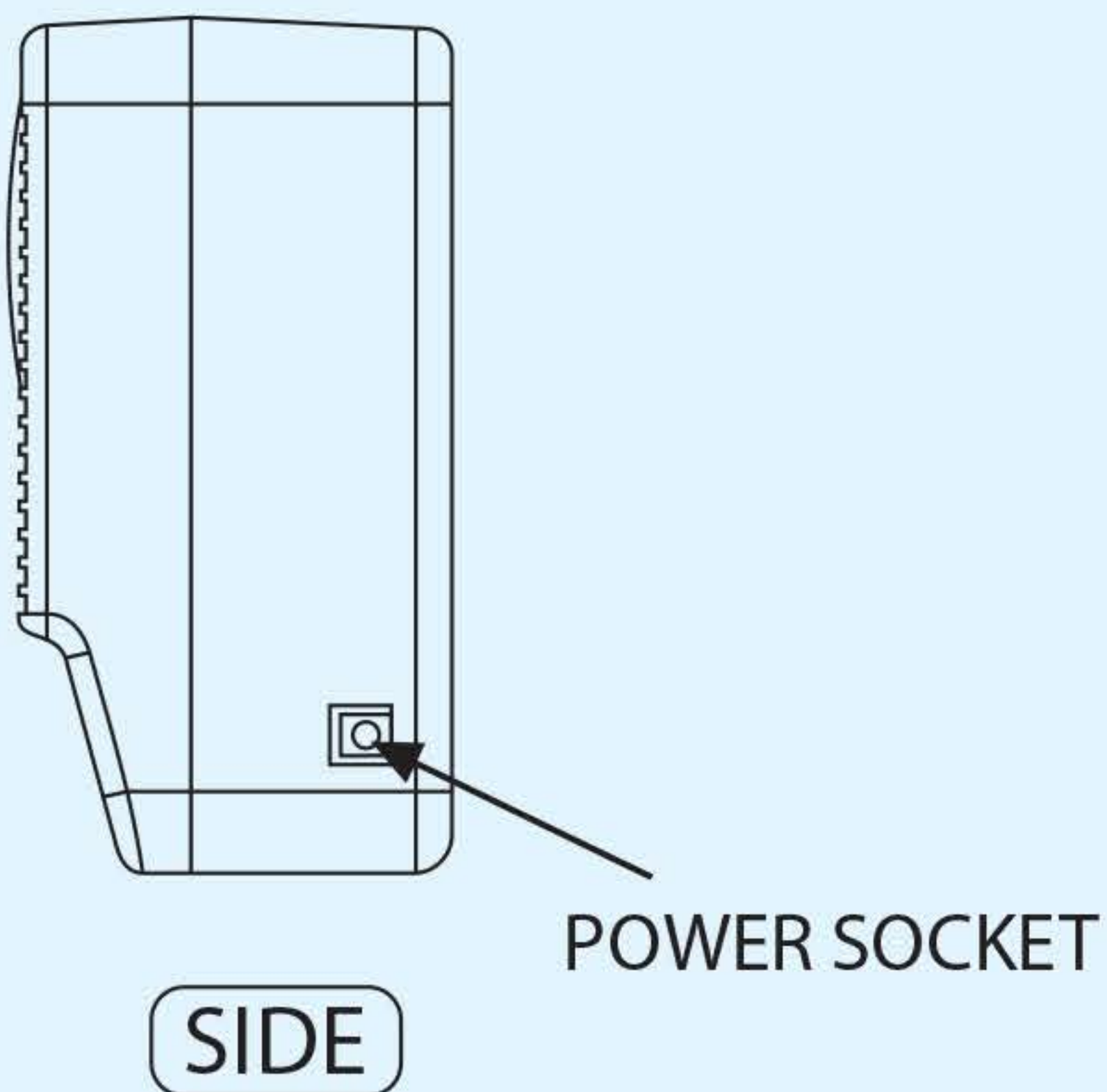
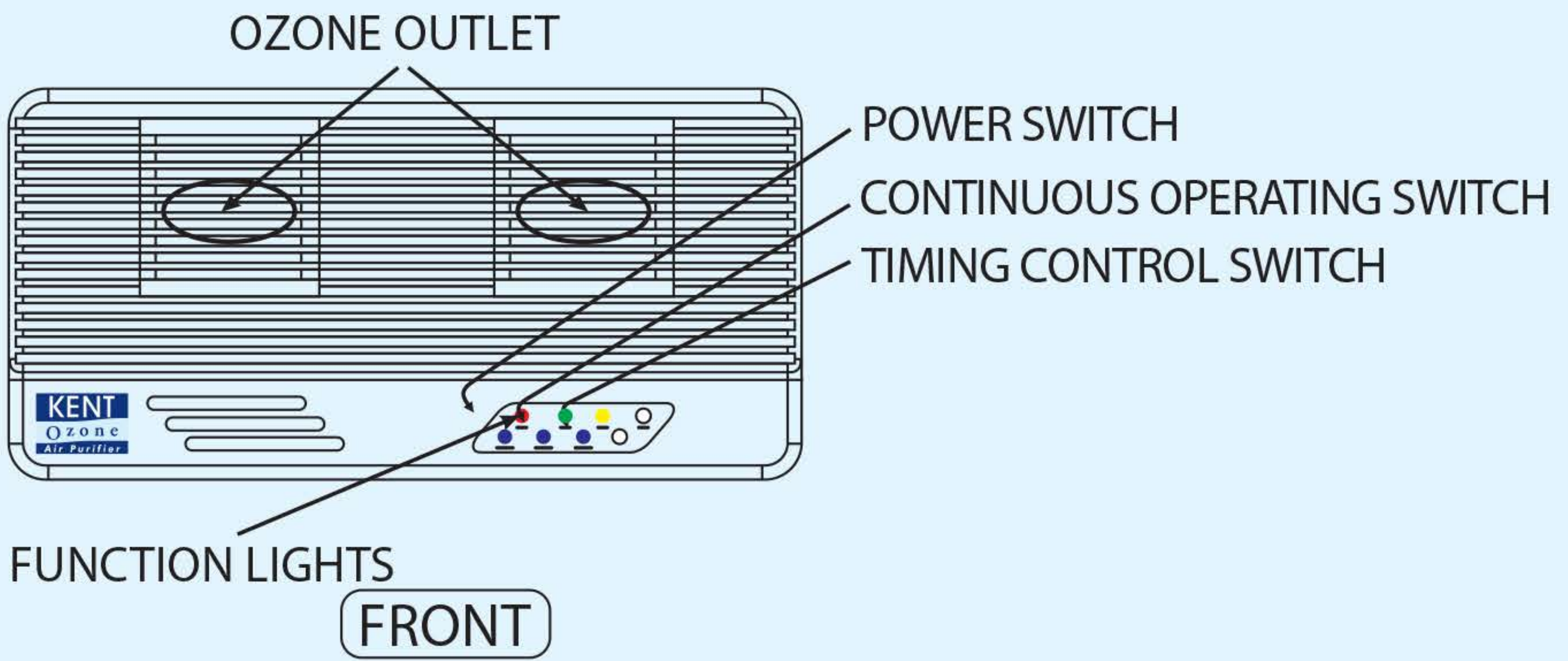
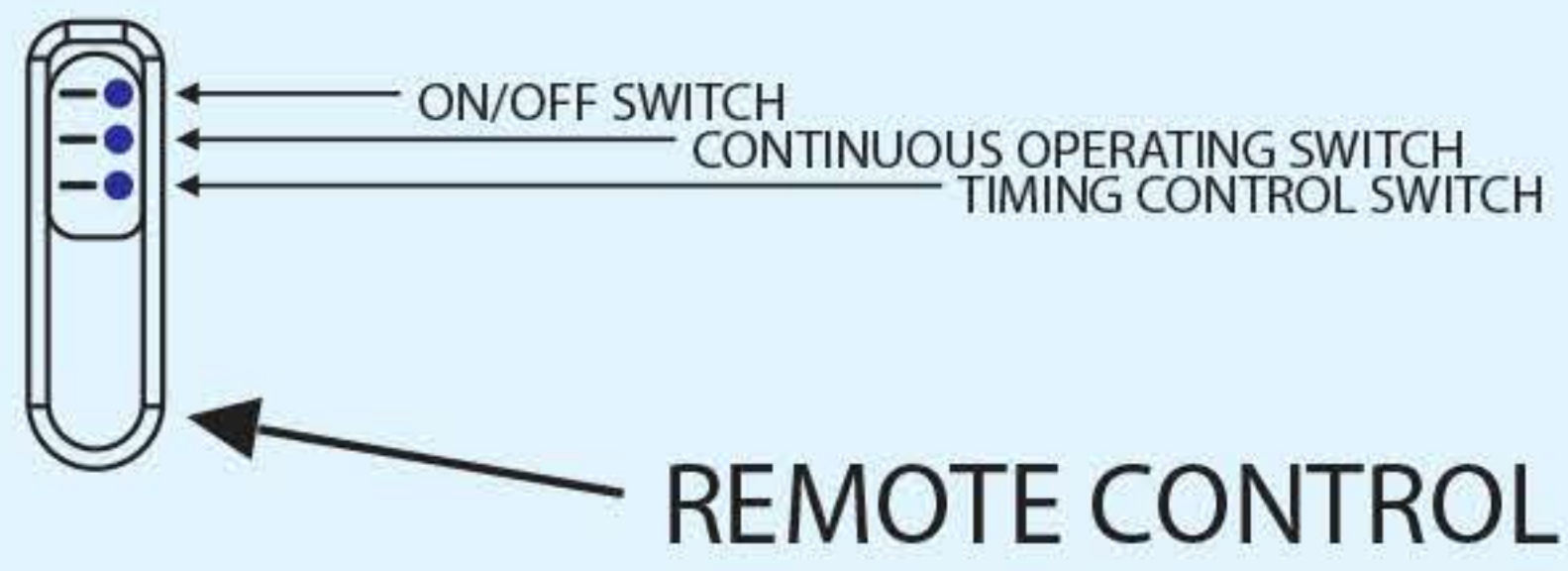

Maintenance

- The inner filter of the device must be cleaned with a soft brush or vacuum cleaner after every 2 weeks or 184 hours of operation.
- Do not wash the device with water or any other chemical solution.

Caution

- The device is not water resistant please do not immerse it in water.
- Clean the device with a soft & dry cloth at regular intervals. Do not use any chemical solution for cleaning the device.
- Replace the adapter or remote when it is out of order. Buy the adapter or remote from Kent or its authorised dealer only.
- Do not try to repair the device on your own, call our Service Engineer.
- Do not encourage any child or a person with weak heart to maintain or clean the device.
- Do not forget to unplug the device while maintaining or cleaning it.
- Keep the device out of the reach of children.
- Consult your physician before trying any of the ozone therapy methods.

Troubleshooting

NO.	Breakdown	Reason & Troubleshooting
1.	The LED Lights are not flashing and the device is not functioning	<ul style="list-style-type: none">• Ensure that the adapter has been properly connected to the power socket, and the on/off switch has been pressed properly.
2.	Amplitude vibration and loud noise	<ul style="list-style-type: none">• If the device is being used in upright method, then it should be kept at a 5mm distance from the wall.• Drill the screws (on the wall) in an even position, If it is not possible then place a rubber pad between the device and wall.
3.	The Adaptor/Remote has malfunctioned	<ul style="list-style-type: none">• Replace the adaptor or remote when it is out of order. Buy the adaptor or remote from Kent or its authorised distributor/dealer only.



HOUSE of PURITY



ISO 9001:2008
Certified



Manufactured by:

KENT RO SYSTEMS LTD.

Unit-2, Khasra No. 93, Village- Bantakhedi
Tehsil-Roorkee, District-Haridwar,
Uttarakhand - 247668, India

Marketed by:

KENT RO SYSTEMS LTD.

A-2, Sector-59, Noida, U.P.-201 309, India
Ph.: +91-120-3075075

E-mail: sales@kent.co.in, Website: www.kent.co.in



Innovations for
Better Living