



HOUSE of PURITY

Imported & Marketed by:  
**KENT RO SYSTEMS LTD.**  
E-6, Sector-59, Noida, U.P.-201 309, India.

For customer complaints, contact our Customer Care Officer at:  
E-6, Sector-59, Noida, U.P.-201 309, India. Call: 92-789-12345  
E-mail: [service@kent.co.in](mailto:service@kent.co.in) or visit us at [www.kent.co.in](http://www.kent.co.in)

Made in People's Republic of China

August 2024

## KENT COLD PRESSED JUICER

Slow RPM Helps Retain Nutrients and Fibers

High Power BLDC Motor | Big Hopper



Automatic Cutting of  
Fruits & Vegetables



Faster Juicing



Double Blade  
Hopper



Powerful 400 W  
BLDC Motor



High Juice Yield



Maintains Higher  
Nutrients in Juice



# Welcome to KENT

Dear Customer,

Congratulations on your purchase and welcome to **KENT**.

At the outset, allow us to thank you for your trust in **KENT Smart Chef Appliances**.

At KENT, we take pride in our reputation for quality products and industry proven performance. We are certain that you will be more than satisfied with the performance of **KENT Cold Pressed Juicer** and that it will serve you and your family's needs without any compromise.

This guide will help you in getting the best out of your appliance. Please go through the booklet to familiarize yourself with its operation and maintenance.

With its robust quality, you can look forward to years of trouble-free service.

To ensure that the warranty of your appliance is effective, it is important that you fill up the enclosed warranty card and mail it to us within 15 days of purchase.

In case you require any further information, please contact your nearest **KENT** dealer / branch.

Bon Appetit!

**KENT RO Systems Ltd.**

## Table of Contents

1.	Introduction	1
2.	Advantages of KENT Cold Pressed Juicer	1
3.	Features of KENT Cold Pressed Juicer	1
4.	Know Your Product	2
5.	Items in the Box	2
6.	Assembling Your KENT Cold Pressed Juicer	3
7.	Ingredients and Tips	4
8.	Content of Fruits & Vegetables	5
9.	Precautions	6
10.	Cleaning & Maintenance	6
11.	Disassembling Your KENT Cold Pressed Juicer	8
12.	Important Safety Instructions	12
13.	Troubleshooting	13
14.	Technical Specifications	14

## INTRODUCTION

We, at KENT, have always believed that a clean and healthy life is the right of every individual. This ethos is what made us embark on the journey to develop innovative solutions for purifying the water that we drink, the vegetables and fruits we eat, the homes we live in and the air we breathe.

Use of innovative technology and the support of a competent service network, have enabled us to create a brand which has become synonymous to well-being. Continuing with the tradition, we now present the **KENT Cold Pressed Juicer** with state-of-the-art technology to provide you and your family a healthy life.

KENT Cold Pressed Juicer employs a slow speed squeezing technique, which not only retains the natural and original taste, but also retains nutrients which are naturally found in the ingredients, making the juice healthy and tasty.

## ADVANTAGES OF KENT COLD PRESSED JUICER OVER CONVENTIONAL JUICERS

1. In a conventional juicer, the nutrients and fiber get oxidized, owing to the heat generated from high speed spinning. On the other hand, KENT Cold Pressed Juicer does not produce as much heat as generated by the conventional juicer, thus keeping the nutrients and fiber intact.
2. For the same quantity of vegetables or fruits, KENT Cold Pressed Juicer gives higher juice yield than conventional juicers. It can also process nuts for the yummiest almond or cashew nut milk shake, which is not possible with conventional juicers.
3. The lower processing speed gives KENT Cold Pressed Juicer a distinctive advantage of low noise, making it quieter than conventional juicers. With KENT Cold Pressed Juicer, one can enjoy their favorite television serials while extracting juice.
4. KENT Cold Pressed Juicer comes with a powerful motor resulting in faster juice extraction and a smoother outflow. These features cannot be matched by the conventional juicers available in the market.

## FEATURES OF KENT COLD PRESSED JUICER

1. Automatic cutting of fruits & vegetables, allows whole produce to be juiced without pre-cutting.
2. The double blade hopper processes quickly for a smoother experience.
3. High juice yield minimizes waste, extracting more juice per produce.
4. Faster juicing with an efficient design and powerful motor suits busy lifestyles.
5. The powerful 400W BLDC motor operates quietly with less heat, preserving juice integrity.
6. The cold press process retains high nutrients by reducing heat and oxidation.
7. Slow-speed squeezing ensures preservation of the nutrients and original taste.
8. The reverse motor action clears the blockages.
9. The body is made of food grade plastic.
10. Easy to assemble & disassemble the appliance components.

## KNOW YOUR PRODUCT

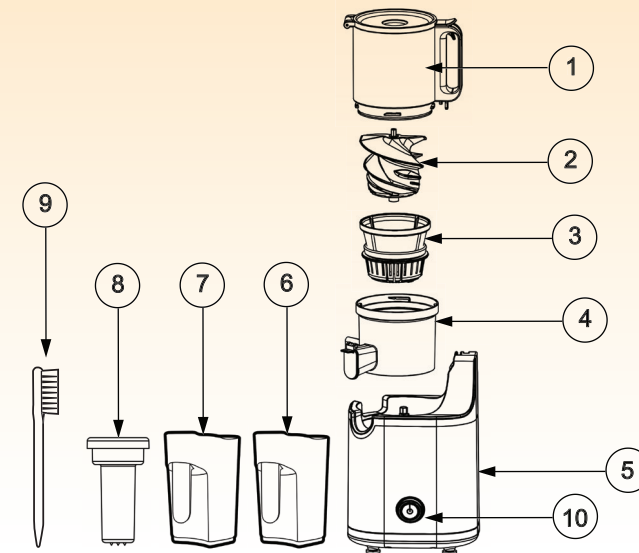

- |                    |               |                   |
|--------------------|---------------|-------------------|
| 1. Feeding Cup     | 5. Power Base | 9. Cleaning Brush |
| 2. Squeezing Auger | 6. Juice Cup  | 10. Control Knob  |
| 3. Filter          | 7. Pulp Cup   |                   |
| 4. Juicing Bowl    | 8. Pusher     |                   |

## ITEMS IN THE BOX

1. KENT Cold Pressed Juicer	:	1 N
2. Juice Cup	:	1 N
3. Pulp Cup	:	1 N
4. Feeding Inlet	:	1 N
5. Juice Container	:	1 N
6. Strainer	:	1 N
7. Filter	:	1 N
8. Pusher	:	1 N
9. Cleaning Brush	:	1 N
10. Squeezing Auger	:	1 N
11. User Manual	:	1 N

## ASSEMBLING YOUR KENT COLD PRESSED JUICER



Fig. 1

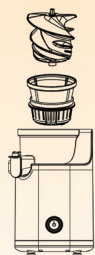

Fig. 2

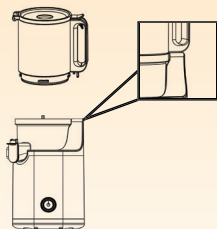

Fig. 4

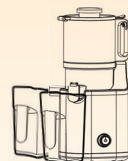

Fig. 4

Fig1. Position the squeezing bowl on the power base aligning the position of the spouts and axle.

Fig2. Push the filter and squeezing auger firmly into the center of the bowl, making sure that it touches down the bottom, or else the cover cannot be closed.

Fig3. Position the feeding cup on the bowl to twist it clockwise until it clicks the safety lock

Fig4. Place the juice container and the pulp container under the relevant spouts.

## OPERATION INSTRUCTIONS

1. Connect the unit with power
2. Check and make sure all parts are well assembled in correct position.
3. Make sure the machine is at "OFF" position.
4. Make sure the juice and pulp containers are in position.
5. Make sure the juice spout cover is closed.
6. Prepare the fruits or vegetables and cut them into pieces max 5cm x 2cm strips or 5cm x 5cm cubes.
7. Put fruit strips/cubes into the chute.
8. Rotate the knob to right to start the juicing operation.
9. Push the food down with the pusher only.
10. In case of food stuck inside the bowl, rotate the knob to left for reverse function instantly.

NOTE: The first use will have odor. It is a normal phenomenon, with the use of increased frequency, the odor will be reduced until it completely disappears.

Please do not use the juicer continuously for longer than 20 minutes.

## INGREDIENTS & TIPS

1. Use fresh fruits and vegetables, as they contain more juice. Particularly suitable for processing in the juicer are pineapples, beetroots, apples, cucumbers, carrots, melons, pomegranate, tangerine, grapes, oranges or sweet lime.
2. You do not have to remove thin peels or skins. Only remove thick peels, e.g. pineapples, beetroots, water-melons, tangerine and sugar beet.
3. Fruits that contain starch, such as bananas, papayas, figs and mangoes are not suitable for processing in the KENT Cold Pressed Juicer. Use a food processor, blender or bar blender to process them.
4. KENT Cold Pressed Juicer is not ideal for fruits or vegetables that are very hard, rich in fibre, or have starch content, e.g. sugarcane, etc.
5. Drink the juice immediately after you have extracted it. If it is exposed to air for some time, the juice will lose its taste and nutritional value.

**Warning:** The machine may stop working due to overload. In that case, press stop button and then press reverse button to make the spiral mixer rotate in reverse direction. This results in the ingredients between the strainer and the mixer to move backward, freeing the mixer. After 15 seconds, the juicer will stop automatically or you can press the stop button. To continue with the juice extraction again press 'Start Forward' button (If the appliance still does not work, repeat the process two to three times).

## CONTENTS OF FRUITS & VEGETABLES

Fruit/ Vegetable	Vitamin/ Mineral Substance	Kilocalorie/Calorie
Apple	Vitamin C	200 g = 150 KJ (72 cal.)
Apricot	Dietary Fibre and Potassium	30 g = 85 KJ (20 cal.)
Sugar Beet	Folic Acid and Dietary Fibre	160 g = 190 KJ (45 cal.)
Blueberry	Vitamin C	125 g = 295 KJ (70 cal.)
Carrot	Vitamin A, B, C and Dietary Fibre	120 g = 125 KJ (30 cal.)
Celery	Vitamin C and Potassium	80 g = 55 KJ (7 cal.)
Cucumber	Vitamin C	280 g = 120 KJ (29 cal.)
Fennel	Vitamin C and Dietary Fibre	300 g = 145 KJ (35 cal.)
Grape	Vitamin C and Potassium	125 g = 355 KJ (85 cal.)
Kiwi Fruit	Vitamin C and Potassium	100 g = 100 KJ (40 cal.)
Nectarine	Vitamin C, Potassium and Dietary Fibre	180 g = 355 KJ (85 cal.)
Peach	Vitamin C, Potassium and Dietary Fibre	150 g = 205 KJ (49 cal.)
Pear	Dietary Fibre	150 g = 205 KJ (60 cal.)
Pineapple	Vitamin C	150 g = 250 KJ (59 cal.)
Strawberry	Vitamin C, Iron, Potassium and Magnesium	125 g = 130 KJ (31 cal.)
Tomato	Vitamin C, Dietary Fibre, Vitamin E, Folic Acid and Vitamin A	100 g = 90 KJ (22 cal.)

## PRECAUTIONS

1. Do not disassemble, repair or alter the appliance on your own. It may cause appliance failure or breakdown.
2. The input voltage must not exceed the rating as it might damage the appliance.
3. Unplug before replacing the filter screen/cleaning/moving the appliance.
4. Do not use the appliance with a damaged power cord or plug. If the power cord is damaged, replace it with a genuine KENT spare.
5. If the appliance is not to be used for a long period, unplug it.
6. This product is for domestic use only.
7. Do not allow children to use this product without supervision.
8. Do not use any accessory or component provided by other manufacturers without proper recommendation. This will jeopardize the validity of your warranty.
9. Check the strainer and spiral mixer components before using the product. Do not use in case of any crack or damage.
10. Check if all the components are properly assembled before turning on the power switch.
11. Do not use the KENT Cold Pressed Juicer until the juice extract assembly is properly locked and a "click" is heard.
12. Do not open the juice extract assembly unless the power is turned off and the filter screen components have stopped working.
13. Do not immerse the motor unit in water or any other liquid. Do not wash, just wipe to clean (it has electrical components inside).
14. Do not allow the appliance to be dropped from a high level. Doing so may damage the unit.
15. Do not use the appliance on tables that are unstable or have poor heat resistance. Doing so may burn their surface.
16. It is strictly prohibited to wash the appliance with chemicals or volatile substances. Doing so may cause color change, color fading and even fire.

## CLEANING & MAINTENANCE

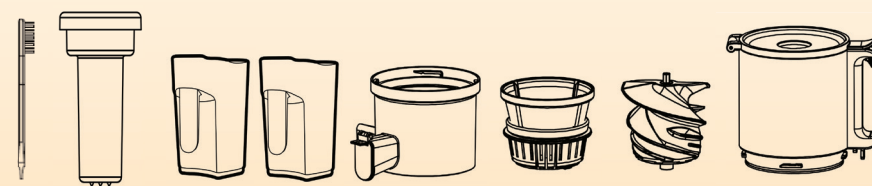

### IMPORTANT:

Please wash the juicing parts every time immediately after each use, otherwise the pulp might stick tightly in juicing bowl & squeezing auger which will then affect the disassembly, cleaning and juicing performance.

1. Switch off and unplug the juicer.
2. Wash the disassembled parts with water. If the meshes are clogged with pulp, please use the provided cleaning brush to remove the dregs.

**Attention:**

- Do not use iron wire brush, abrasive or sharp object tool to clean the unit.
  - Please do not use water above 40°C/104°F.
  - Do not put in the dishwasher.
3. In case there is any residues remained in the mouth of the pulp spout, please pull out the silicone valve as shown in (Fig 1) below and clean under running water.

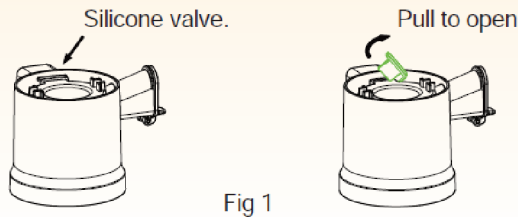

Fig 1

**Press the silicone valve to close it properly and tightly after cleaning.**

4. To clean the seal ring in the center of the squeezing bowl, please follow the steps as below :
  - Turn the squeezing bowl upside down for easier handling. Push the seal ring out with your thumb (Fig 2a) and clean it with water.
  - After cleaning, please put it back to the center hole. The small ribbed surface should face upward (Fig 2b). Make sure the groove of the seal ring well fit in the squeezing bowl. The big flat size of the seal ring will be inside while the small and ribbed side is outside the squeezing bowl. (Fig 2c)

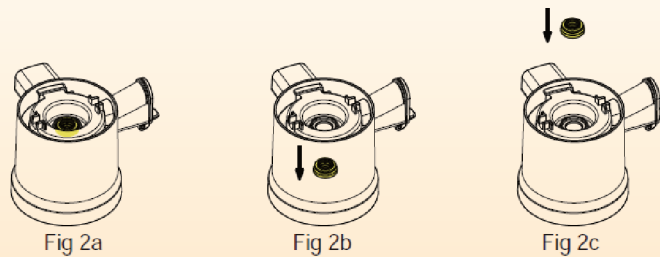

Fig 2a

Fig 2b

Fig 2c

5. Do not put the power base into water for cleaning. Wipe it with damp cloth only.
6. After cleaning, please dry the parts thoroughly and store them in a dry, cool place.

**NOTE:** Please make sure the unit and parts are dry before storing it.

**Storage:**

1. Follow cleaning instructions to well maintain the unit before storage.
2. Tidy up the power cord set.
3. Keep the unit away from children's easy access.
4. Store the unit and the accessories at a dry, cool place.

## DISASSEMBLING YOUR KENT COLD PRESSED JUICER

Before cleaning, disassemble the KENT Cold Pressed Juicer in the following manner:

1. Remove the juice and pulp containers.



2. Remove the feeding cup. Turn the chute anticlockwise.

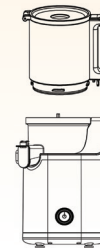

3. Remove the squeezing auger and filter by pulling it out upward. If it is very hard, swing gently and pull.

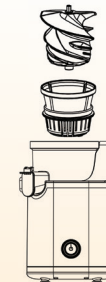

4. Remove the squeezing bowl by lifting it upward vertically.

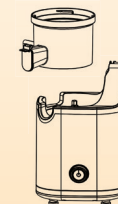

**Warning**

- Never immerse the motor unit in water nor rinse it under the tap.
- Do not wash the strainer with bare hands in case of starch.

# WARRANTY CARD

(For sale through dealer)

Product: **KENT COLD PRESSED JUICER**

Serial No.: .....

## Customer Details:

Customer's Name: .....

Customer's Address: .....

Customer's Phone No.: .....

## Warranty Details:

Invoice Date: ..... Invoice No.: .....

## For Service Contact:

Service Provider's Name: .....

Service Provider's Address: .....

Ph. No.: .....

Marketed by: **KENT RO SYSTEMS LTD.**

E-6, Sector-59, Noida, U.P. -201309, India

E-mail: [service@kent.co.in](mailto:service@kent.co.in) | Website: [www.kent.co.in](http://www.kent.co.in)

Customer Care: 92-789-12345

## TERMS & CONDITIONS OF WARRANTY

KENT warrants all new products manufactured by it to be free from defects in material and workmanship under normal usage and service from the date of purchase as under:

1. The Warranty period commences from the date of purchase by the first end-user. During this Warranty period of one year, KENT or its Authorized Service Provider (ASP) will replace or repair any part of KENT Cold Pressed Juicer, that in the opinion of KENT or its ASP, would be defective in operation due to faulty material or workmanship (i.e. manufacturing defects) with the exception of consumables.
2. The product's plastic body is not covered under Warranty and hence, it must be handled with care to guard against breakage.
3. The original purchaser of the unit can avail services under Warranty at the point of sale, by producing the damaged part(s) along with the original invoice.
4. This Warranty is void if the unit is not operated under normal conditions or according to the instructions given in the manual.
5. Product returned to KENT or its ASP for Warranty examination must be shipped freight prepaid.
6. KENT or its ASP shall not be held liable for claims exceeding the cost of repair of the defects in workmanship.
7. This Warranty Agreement shall not be interpreted to render KENT or its ASP liable for injuries or damages of any kind - direct, consequential or contingent to persons or property.
8. KENT or its ASP shall not be held responsible by representative or buyer for failure to abide by any of the obligations of this Warranty Agreement if such failures are the result of circumstances of Forces Majeures: such as, but not limited to, floods, earthquakes, transportation strikes, labour disputes with outside suppliers or any other conditions beyond the control of KENT or its ASP.
9. KENT or its ASP shall not be held liable for repair or alterations made without prior written approval; for products failures resulting from the lack of proper maintenance.
10. This Warranty Agreement excludes all products/component parts or damage to any part of this KENT Cold Pressed Juicer which, in the opinion of KENT or its ASP, have been subjected to misuse; misapplication; negligence; alteration; accident or operation contrary to our instructions, incompatibility with accessories not installed by KENT or its ASP, or that have been repaired with component parts other than those manufactured by or obtained from KENT or its ASP. Damage caused by freezing, flood, fire or Act of God is not covered by this Warranty. In all such cases regular charges will apply. This limited Warranty does not include service to diagnose a claimed malfunction in this unit.
11. KENT reserves the right to alter or improve design and specifications at any time, without any contingent obligations to prospective buyers or owners of the products previously sold.
12. Any disagreements and obligations based upon the purchase of KENT products and thereby imposed on KENT or its ASP shall be governed by and construed according to the laws of India and subject to the jurisdiction of Delhi Courts only.
13. KENT or its ASP assumes no Warranty liability in connection with this KENT Cold Pressed Juicer other than that specified herein. This Warranty is in lieu of all other warranties, expressed or implied, including warranties of fitness for a particular purpose. KENT or its ASP does not authorize any person or representative to assume for them any other obligations on the sale of this Cold Pressed Juicer.
14. Under no circumstances, the liability of KENT or its ASP shall exceed the value of the product.
15. Under no circumstances are the terms mentioned above negotiable and no employee of KENT or its ASP has the authority to supersede them.

## IMPORTANT SAFETY INSTRUCTIONS

When using an electrical appliance, basic precautions should always be followed, including the following:

1. Unplug when not in use and before servicing.
2. To reduce the risk of electric shocks, do not use near or on wet surfaces.
3. Use the appliance only as described in the manual.
4. Do not use the appliance if the cord or the plug is damaged or worn out. Replace the damaged cord or plug immediately.
5. Do not try to service the appliance on your own. Send it to an authorized service center only.
6. Keep the cord away from heated surfaces.
7. Do not unplug the appliance by pulling the cord. Always unplug by pulling out the plug.
8. To avoid electric shocks, do not use the appliance with wet hands.
9. Keep hair, loose clothing, fingers and all parts of the body away from moving parts.
10. Turn all controls off before unplugging.
11. Never use the appliance without the strainer in place.
12. This appliance is suitable for indoor use only.
13. Keep away from children.



## TROUBLESHOOTING

PROBLEM	POSSIBLE CAUSE	POSSIBLE SOLUTION
The juicer stops running suddenly.	Too many ingredients put into the juicer	Rotate "I" to "REV" position instantly to make the ingredients return upwards. If the machine still stops running, please clean the machine before use.
	Hard fruits or vegetables have not been cut in small pieces.	Hard fruits and vegetables (such as carrot) shall be cut into thin strips or small cubes before putting into chute.
	Juicer turns off automatically for over heated protection.	Wait one hour to cool and turn on the juicer again.
The juice yield is low or juice flows out of the main housing.	The bowl and the silicone valve are not installed properly.	Please re-install the bowl's silicone valve by referring to the installation method.
Abnormal noise	Parts cause extrusion sound during squeezing.	The sound is caused by extrusion of fruits and vegetables, which is normal phenomenon.
The container & accessories are dyed after use.	There is too much pulps inside the bowl.	Rotate "I" to "REV" position setting to eject the pulps backward.
	There is hard foods stuck inside.	Rotate "I" to "REV" position to eject the object backward.
	The pulp mess is stuck.	Pour water into the feeding cup and wait for few hours
The container & accessories are dyed after use.	Dyed parts are due to natural color of specific fruits/veggies.	This is natural color and unavoidable.

## TECHNICAL SPECIFICATIONS

Product Name	KENT Cold Pressed Juicer
Product Code	116006
Net Quantity	1N
Net Weight	4.4 kg
Input Power Supply	Single Phase 220 V AC, 50 Hz
Power Consumption	400 W

