



# TOUCHLESS SANITISER DISPENSER

INSTRUCTION MANUAL



**Marketed by:**

**KENT RO SYSTEMS LTD.**

E-6, 7 & 8, Sector-59, Noida, U.P.-201 309, India.

E-mail: [sales@kent.co.in](mailto:sales@kent.co.in) | Website: [www.kent.co.in](http://www.kent.co.in)

**Manufactured by:**

**KENT RO SYSTEMS LTD.**

A-6, Sector-87, Noida-201 305, U.P., India.

E-mail: [sales@kent.co.in](mailto:sales@kent.co.in)

For customer complaints, contact Customer Care Officer at:  
E-6, 7 & 8, Sector-59, Noida, UP-201 309, India. Call: 92-789-12345  
E-mail: [service@kent.co.in](mailto:service@kent.co.in) or visit us at [www.kent.co.in](http://www.kent.co.in)



Tank  
Capacity  
**1000ml**



# Welcome to KENT

## TABLE OF CONTENTS

Dear Customer,

At the outset, allow us to thank you for your trust in **KENT**. We take pride in our reputation for product quality and industry proven performance. We are certain that your decision to own a **KENT Touchless Sanitiser Dispenser** will go a long way towards keeping you and your employees in good hygiene and health. We are confident that you will be satisfied with its performance and that it will serve your need for safer premises without any compromise on hygiene and cleanliness.

This guide will help you in getting the best out of your **KENT Touchless Sanitiser Dispenser**. Please go through this booklet to familiarise yourself with its operation and maintenance.

Best Wishes,

KENT RO SYSTEMS LTD.

1. <b>KENT</b> Touchless Sanitiser Dispenser	1
2. Features	1
3. Know Your Product	1
4. Items in the Box	1
5. Installation Instructions	2
6. Indicator Lights	3
7. Cleaning & Maintenance	3
8. Important Safety Instructions	3
9. Technical Specifications	4

## KENT Touchless Sanitiser Dispenser

KENT proudly presents KENT Touchless Sanitiser Dispenser, which will go a long way towards keeping you and your family in good hygiene and health. We are confident that you will be satisfied with its performance and that it will serve your need for better hygiene and cleanliness.

### FEATURES

- Translucent container for sanitiser
- High storage capacity of 1000 ml
- Single and double spray option
- Removable sanitiser container for cleaning and easy refilling
- Fully automatic and touchless use for hands-free operation
- Works with both batteries & adapter
- Wall-mountable

### KNOW YOUR PRODUCT

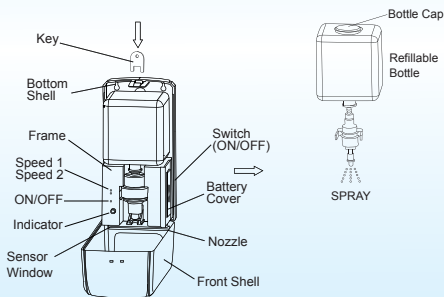

### ITEMS IN THE BOX

- |                                       |       |
|---------------------------------------|-------|
| 1. KENT Touchless Sanitiser Dispenser | : 1 N |
| 2. Screw Bag with Key                 | : 1 N |
| 3. Warranty Card                      | : 1 N |

## INSTALLATION INSTRUCTIONS

### Installation Procedure

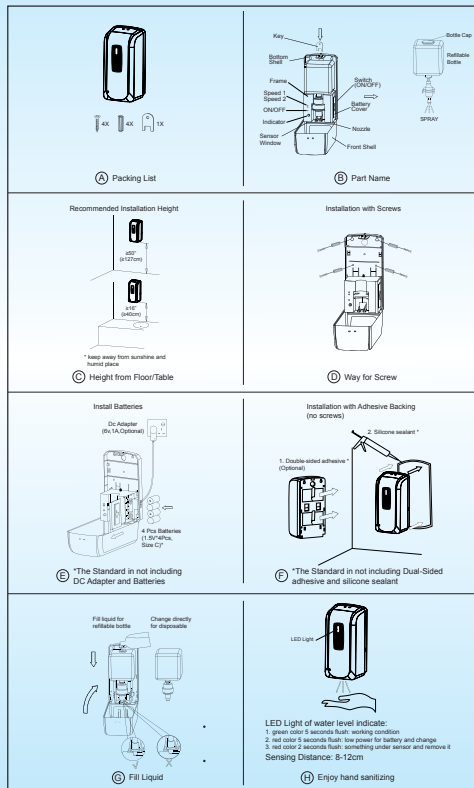

## INDICATOR LIGHTS

There are 2 operation modes-single spray mode & double spray mode. These modes can be activated by pressing respective buttons.

- Green light: single spray
- Red light: double spray

**Note:** Sensing Distance: 8-12cm

## CLEANING & MAINTENANCE

- After starting to use the machine, if it is left unused for many days, the evaporation of water in the pipeline will cause the sanitiser to coagulate, which will have a certain impact on the pump. It is advised to store the sanitiser bottle separately from the machine
- If the machine has not been maintained for more than 3 months, then the pump may not function properly in such case remove the bottle, open the cap, and pour warm water around 40°C into the bottle. [warm water at about 40°C has a better chance of dissolving the sticky stuff in pipes]. Put the liquid bottle back on the machine and start using it as usual until water comes out of the outlet. Repeat 10-15 times for better results

## IMPORTANT SAFETY INSTRUCTIONS

- Do not place the product on places that are subject to vibration or shock, such as on a wobbling table or an unstable tilted place
- Do not bump, apply excessive force, or scratch. It may cause damage
- Do not wipe the main unit with thinner or benzene. It may cause deformation or discoloration
- Do not install the product in a place close to fluorescent lamps expose it to strong light. It may cause malfunctioning
- Make sure that the sensor unit is not exposed to liquid. The sensor may stop responding. In case you choose not to use the unit for an extended period of time, empty the container of sanitiser
- In case of no use, clean the dispenser and remove the batteries. Store it in a dry place
- Sanitiser works best with this sanitiser dispenser

## Battery Safety

- Do not mix the old batteries with the new ones
- Do not use rechargeable batteries as it may affect the proper functioning of the unit
- Please remove the batteries if the unit is not being used for a long time
- Batteries are small objects and must be replaced by an adult
- Use appropriate batteries, 4 Nos. C 1.5V Batteries

## TECHNICAL SPECIFICATIONS

Product	: KENT Touchless Sanitiser Dispenser
Product Code	: 112016
Product Generic Name	: Sanitiser Dispenser
Product Colour	: White
Mounting	: Wall Mountable
Input Power Supply	: 6 V, 4 Nos. C 1.5V Batteries [Not Included]
Capacity	: 1000 ml
Dispensing Qty.	: Adjustable amount
Net Weight	: 0.77 kg
Product Dimensions [mm]	: 120 (L) X 117 (W) X 260 (H)
Total Power Consumption	: 1.2 W